

LumiStar 2000

Advantages:

- Ultra-bright LED: 2000 lumens, three times the output of a 100W halogen lamp.
- 24° TIR Lenses: Designed for optimal light output with less than 5% light loss.
- Color temperature 5500K: Optimal for stainless steel tanks.
- Cold operation: Current constraints and automatic illumination.
- Durable LEDs: Resistant to vibrations and impacts.
- No radiated heat: Cool light emission.

Application:

Ideal for tank illumination in the brewing, chemical, pharmaceutical, biotechnology, and food sectors.

Attaches to sight glass fittings for either combined or individual ports (1 or 2 ports).

Appropriate for brewing tanks, bioreactors, mixers, filters, tanks, hoppers, silos, agitators, separators, and pipelines in non-hazardous environments.

Compatible with the subsequent nominal sizes:

- Circular sight glass fittings welded to DIN 28120: starting from size DN 50 (sight diameter 3")
- ANSI circular bolt-on sight glass window: starting at size 2"
- Visual flow indicators: starting from size 2"
- MV series circular sight glass fittings with welded neck, starting from DN 50.
- MetaClamp Sanitary Flange Fitting: starting at 1"

Protection:

- Dust and water jet tightness in accordance with IP 65 as specified by DIN EN 60529/DIN VDE 0470 Part 1.

Terms of Service:

- Approved for ambient temperatures ranging from -40°C to +80°C.
- Do not use to seal tank openings. A proper sight glass fitting is necessary.

Electrical specifications:

Includes a cable gland or 5-pin M12 connector, along with a 3-meter power cable.

Functionality:

- Three modes: Torch, Timed, Direct.
- Factory programming: Timer, brightness, LED activation.
- Remote switch is available.

Operating voltage:

- **Low voltage: 24V (AC or DC)**
- High voltage: 110-240V AC

USL 15



USL 35



<https://www.gallet-fr.com>

LumiStar2000™ USL15/35 Luminaire Specifications and Electrical Information

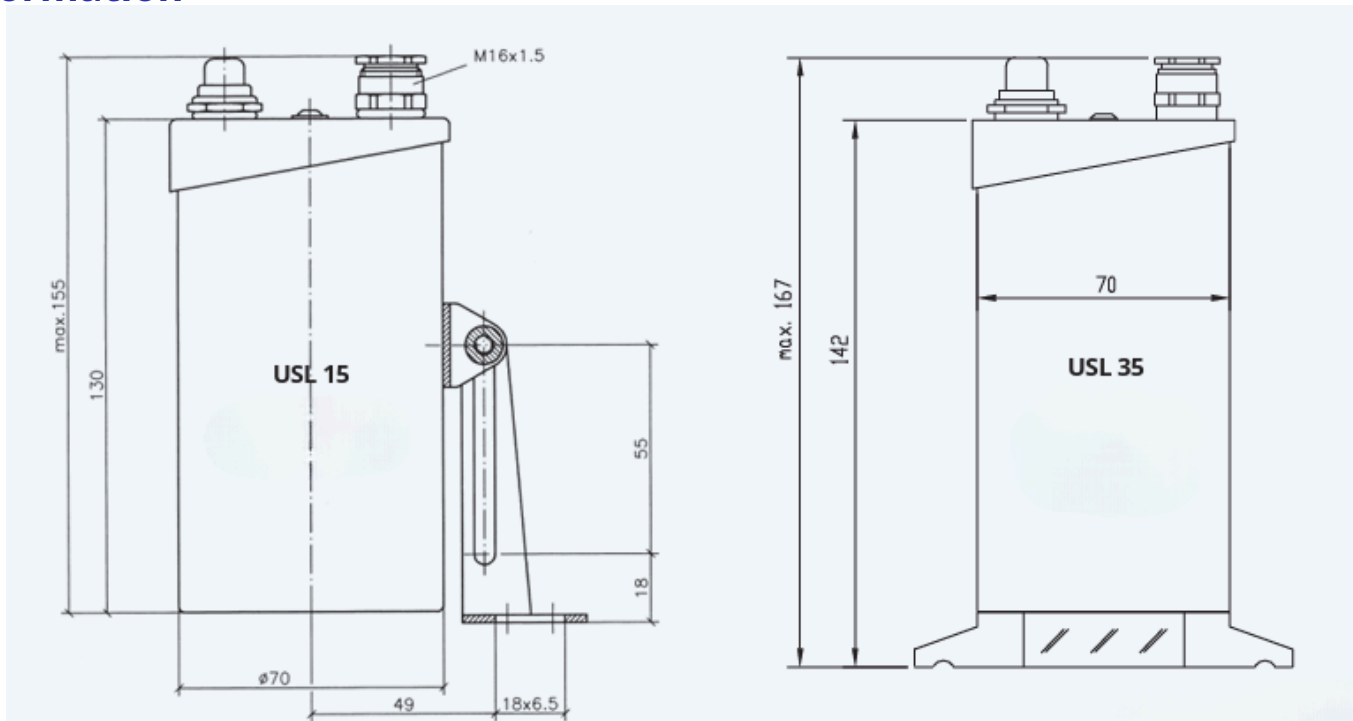

Components and materials:

- Luminaire body and cap: 316 (1.4404) stainless steel
- Mounting components: 304 (1.4301) stainless steel (articulated bracket or flanged adapter neck for installation on Weldneck MV sight glass fitting sizes DN 50 and 65)
- MetaClamp Sanitary Fitting: Duplex stainless steel, Hastelloy, or Monel with borosilicate glass in accordance with DIN 7080.
- Optional Polymer and Metal Sanitary Fitting: 316 Stainless Steel with Transparent Food-Grade Polymer
- Connection cable: 3-meter cable featuring a cable gland or M12 female connector
- Weight: 2 lbs (0.91 kg)

The LumiStar2000 USL15/35 luminaires are appropriate for installation:

- Featuring a fused Metaglas® sight glass for sanitary applications (MetaClamp®) designed for flanged fittings.
- Featuring a fused Metaglas® sight glass for aseptic weld neck fittings, MV Series
- Featuring a fused Metaglas® sight glass for TCI ClampConnect® and Bolt-Connect®
- Featuring a fused Metaglas® sight glass for NA-Connect® fittings
- Featuring a fused Metaglas® sight glass for VARIVENT® in-line housings



LumiStar2000 USL 15/35 featuring a programmable on/off switch.

<https://www.gallet-fr.com>